Fire-rated aluminum fixed windows-MARINE

ALUFLAM® has pioneered the innovative solution to what was long considered an impossible dream (and a barrier to truly beautiful commercial architectural design), the development of rugged, versatile aluminum framing technology for fire-rated commercial window applications.

The ALUFLAM system has been tested and approved and is available to the architectural and construction communities worldwide.



Features:

- The clean, sharp lines of narrow stile aluminum framing
- Large, wire-free glass areas
- Barrier to radiant heat through insulated frame and glazing
- Increased design freedom
- Tested and approved to national and international fire codes
- Multitude of finish options

- Simple to install
- High impact resistance
- No corrosion
- Energy efficient
- Reduced noise transmission
- Available in single leaf or double design
- Interior and exterior installation
- B15/ A60 ratings

Framing:

The revolutionary all-aluminum framing system is based on high quality extruded profiles, filled with a proprietary insulating compound.

Glazing:

Alufam incorporates Vetrotech Saint Gobain clear laminated fire glazing. Glazing conforms to ISO 614; ISO 3254; ISO 1095. The Alufam system is approved with both Contraflam and Contraflam Lite glazing which feature superior heat barrier properties.

Finishes:

Alufam can offer a number of factory prefinished coatings for its fire-rated aluminum products.

These include:

- Anodizing
- Powder coating
- Architectural paint finishes

Listings:

These windows are certified by Bureau Veritas acc. to IMO Resolution A.754 (18).

File numbers: PG11324 / 99R1 3211 B
P998/01-530-1

Documentation:

Go to www.alufam.com/int/products-marine-windows-fixed.php

- CAD drawings
- CSI specifications
- Installation instructions

Rev: February 2010

Alufam A/S, Langebjergvænget 13, 4000 Roskilde, Denmark
Tel. +45 4675 0611 Fax +45 4675 0811 www.alufam.com
Copyright © 2010 Alufam A/S

Fire-rated aluminum fixed windows- MARINE

Description

Fixed window

Designation	FW
Fire classification	B15 / A60
Maximum framesize (mm.)	1200x2175 / 1150 x 2030
Frame width (mm.)	62
Frame depth (mm.)	85
Frame weight (kg/m.)	4,42
Glass weight (kg/m ²)	34 / 52
NB File number	PG11324 / 99R1 3211 B / P998/01-530-1

Looking for custom solutions?

Aluflam can provide a variety of custom solutions - both on framing and glass. Contact us for details!

Framing

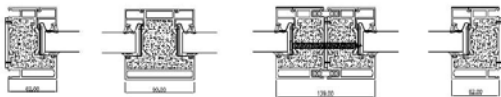
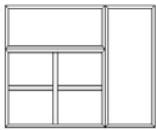

Looking for custom solutions:
Aluflam can provide a variety of
custom solutions- both on glass
and framing.
Contact us for details!

Finishes

Aluflam can offer a number of factory pre-finished coatings for it's fire-rated aluminum products.
These include:

- Anodizing
- Epoxy powder coats
- Architectural paint finishes

Rev: February 2010

Aluflam A/S, Langebjergvænget 13, 4000 Roskilde, Denmark
Tel. +45 4675 0611 Fax +45 4675 0811 www.aluflam.com
Copyright © 2010 Aluflam A/S



See our website for our full range of design options : www.alufam.com

Contact: Alufam A/S - A complete list of approved Alufam representatives is available online at www.alufam.com/contact

E-mail: info@alufam.dk

Rev: February 2010

Alufam A/S, Langebjergvænget 13, 4000 Roskilde, Denmark
Tel. +45 4675 0611 Fax +45 4675 0811 www.alufam.com
Copyright © 2010 Alufam A/S